

PG10500E

NO.	DESCRIPTION	NO.	DESCRIPTION
1	FUEL TANK	38	STATOR FIXING BOLT
2	BUSHING	39	STANDARD SPRING WASHER
3	OIL TANK DAMPING RUBBER PAD	40	STATOR FIXING NUT
4	FUEL CONTROL VALVE	41	ROTOR BOLT
5	FLAT WASHER	42	FLAT WASHER
6	BOLT	43	STATOR
7	FUEL METER	44	ROTOR
8	CROSS RECESSED CONTERSUNK HEAD SCREW	45	WIND SCOOPER
9	FUEL FILTER	46	PANEL MAIN WIRE HARNESS ASSEMBLY
10	FUEL TANK CAP	47	PANEL REAL COVER
11	FRAME	48	RECTIFIER BRIDGE
12	SHOCHPROOF FOOT(RIGHT)	49	POWER SOCKET ASSEMBLY
13	NUT-FINE THREAD	50	POWER SOCKET ASSEMBLY
14	SHOCHPROOF FOOT(LEFT)	51	TERMINAL
15	BATTERY BAND	52	TERMINAL
16	BATTERY	53	VOLTMETER
17	NEGATIVE LINE	54	SINGLE POLE CIRCUIT BREAKER
18	POSITIVE LINE	55	CONTROL PANEL BODY
19	NUT	56	CONTROL PANEL BODY (SWITCH BOTTOM PLATE)
20	ALTERNAOR BRACKET DAMPER BLOCK	57	SWITCH ASSEMBLY(ELECTRIC)
21	SHOCHPROOF FOOT(RIGHT)	58	BOLT
22	UNIT POWER	59	HAND TUBE SUPPORT
23	AIR FILTER BRACKET	60	HAND TUBE
24	BOLT	61	HAND TUBE RUBBER COVER
25	ALTERNATOR RIGHT COVER STOPPER	62	BOLT
26	EXHAUST GASKET	63	ALL-METAL NUT
27	MUFFLER	64	SUPPORT FOOT
28	BOLT	65	SUPPORT FOOT RUBBER COVER
29	STATOR BOLT	66	BOLT
30	CARBON BRUSH	67	NUT
31	TERMINAL	68	FLAT WASHER
32	BOLT	69	FRONT WHEEL AXLE
33	REAL COVER	70	THE FRONT WHEEL
34	NUT	71	COTTER PIN
35	BOLT	72	FLAT WASHER
36	AVR		
37	ALTERNATOR BRACKET		

PG10500E-EX-CK03P202201005

ENGINE FOR PG1050E

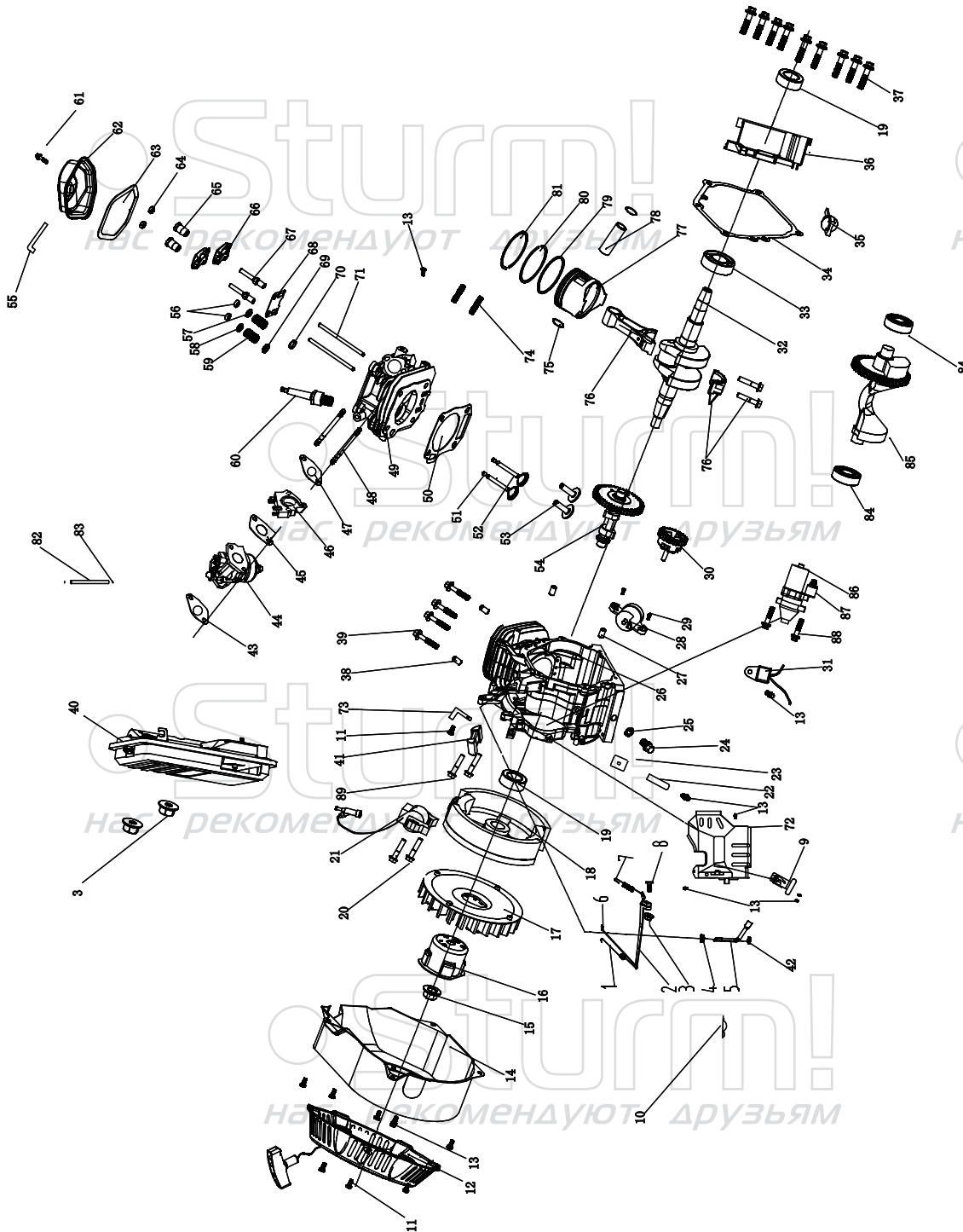

NO.	DESCRIPTION	NO.	DESCRIPTION
1	RESET SPRING(THROTTLE VAVLE)	46	INSULATION BOARD
2	CONTROL ASSEMBLY		(CARBURETOR)
3	NUT	47	AIR INLET GASKET
4	CONNECTING ROA OIL SEAL	48	DOUBLE-SCREW BOLT
5	GOVERNOR ARM	49	CYLINDER HEAD
6	GOVERNING PULL ROD	50	CYLINDER HEAD GASKET
7	GOVERNING SPRING	51	INTAKE VAVLE
8	FIXING BOLT OF SPEED CONTROL BRACKET	52	EXHAUST VAVLE
9	OIL CONTROL SET	53	VAVLE LIFTER
10	COTTER PIN	54	CAMSHAFT ASSEMBLY
11	BOLT	55	WASTE PIPE
12	RECOIL STARTER	56	VALVE ADJUSTING CAP
13	BOLT	57	EX-HAUST VAVLE SPRING SEAT
14	RECOIL STARTER	58	EX-HAUST VAVLE SPRING SEAT
15	NUT	59	VAVLE SPRING
16	STARTING PULLEY	60	SPARK PLUG
17	FLY WHEEL	61	CYLINDER HEAD BOLT ASSEMBLY
18	FLY WHEEL SET	62	CYLINDER HEAD COVER
19	OIL SEAL	63	CYLINDER HEAD GASKET
20	BOLT	64	NUT
21	IGNITOR COIL	65	NUT
22	WIRE CLAMP	66	VAVLE ROCKER ARM
23	RUBBER STOPPER	67	ROCKER SHAFT BOLT
24	BOLT	68	PLATE PUSH GUIDE
25	GASKET	69	OIL SHIELD
26	CRANKCASE	70	VALVE SPRING SEAT
27	LOCATION PIN	71	VAVLE LIFTER
28	OIL ALERT	72	CYLINDER HEAD WIND SCOOPER
29	BOLT	73	CHARGING COIL CLAMP
30	GOVERNOR GEAR SET	74	DOUBLE-SCREW BOLT
31	OIL PROTECTOR	75	CLIP(PISTON PIN)
32	CRANKSHAFT	76	CONNECTING ROD
33	DEEP GROOVE BALL BEARING	77	PISTON
34	GASKET(CRANKSHAFT)	78	PISTON PIN
35	OIL GUAGE SET	79	PISTON RING
36	CRANKCASE COVER	80	PISTON RING
37	BOLT	81	PISTON RING
38	LOCATION PIN	82	FUEL PIPE
39	CYLINDER HEAD BOLT	83	CLAMP(FUEL PIPE)
40	AIR CLEANER ASSY	84	DEEP GROOVE BALL BEARING
41	CHARGING COIL	85	BALANCE SHAFT
42	GOVERNOR ROD GASKET	86	STARTING MOTOR
43	GASKET(AIR CLEANER)	87	STARTING RELAY
44	CARBURETOR	88	BOLT
45	GASKET(CARBURETOR)	89	BOLT

PG10500E-EX-CK03P202201005